

How to manage BOMs (Bills of Materials)

1.About BOMs

●You can generate BOMs by selecting items or importing *a file. (*in designated Excel format)

Your selected items can be saved in BOMs. Also BOM customization is be available at any time after its registration on our website. (e.g. various contents download, rough estimates, item replacement, etc.)

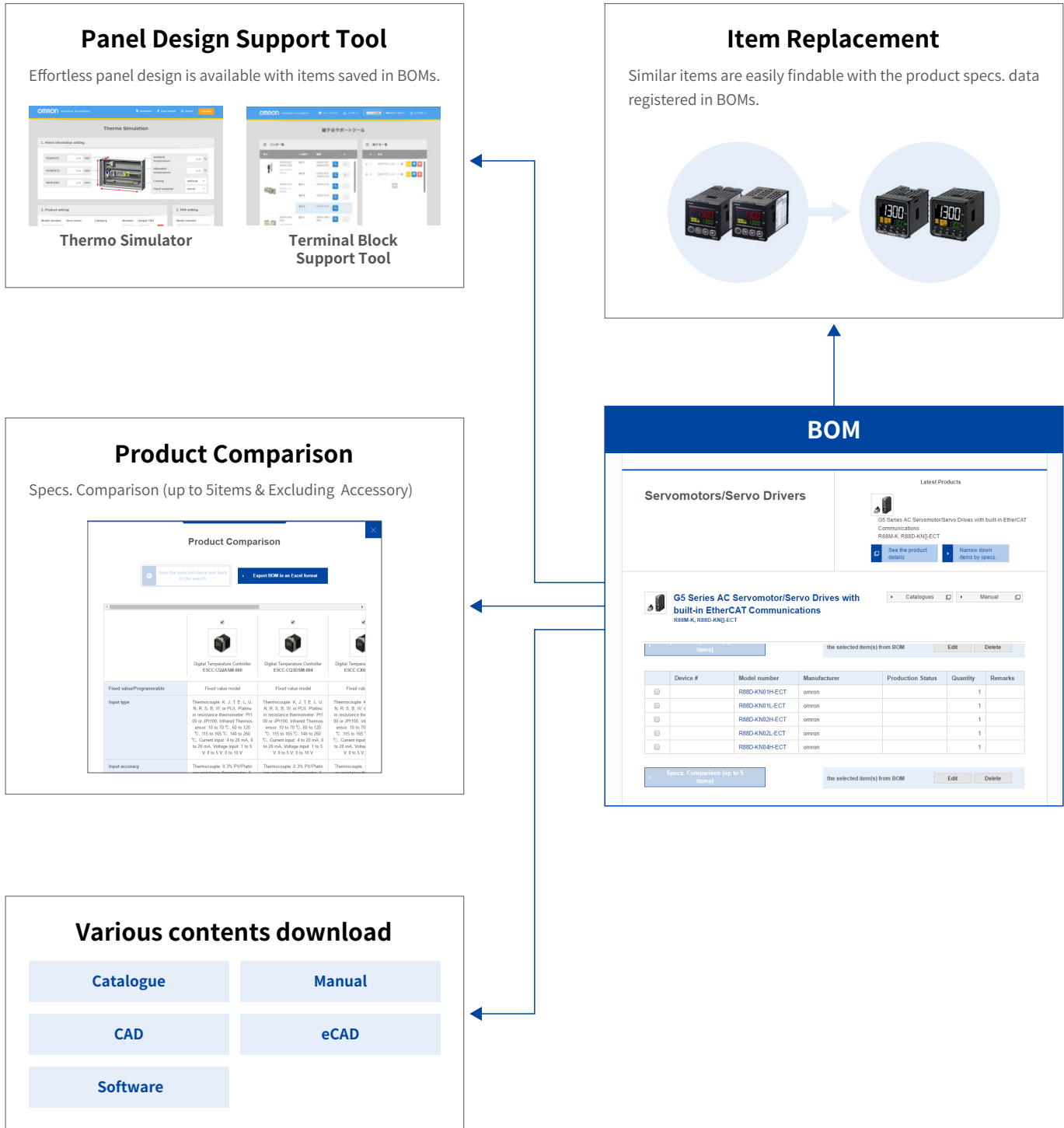

*The instruction image may be different from the actual web pages.

2.How to use BOMs

●BOM Registration

①To save selected items

(1) Tick the boxes to select items from lists.

Total: **24** found
1~20/24 Item(s) found

Specs. Comparison (up to 5 Items)

Product Name	Model number	Product Description	Accessory	Production Status
<input checked="" type="checkbox"/> Digital Temperature Controller	E5DC-CX0ASM-015	100 to 240 VAC, 1-point input, Platinum resistance thermometer/Thermocouple/Infrared Thermosensor/Analog input, Event inputs Not provided, Output: Linear current 1-point, Terminal block, Black	<input checked="" type="checkbox"/> Visible	
<input checked="" type="checkbox"/> Digital Temperature Controller	E5DC-CX0DSM-015	24 VDC 24 VAC, 1-point input, Platinum resistance thermometer/Thermocouple/Infrared Thermosensor/Analog input, Event inputs Not provided, Output: Linear current 1-point, Terminal block, Black	<input checked="" type="checkbox"/> Visible	
<input type="checkbox"/> Digital Temperature Controller	E5DC-CX2ASM-000	100 to 240 VAC, 1-point input, Platinum resistance thermometer/Thermocouple/Infrared Thermosensor/Analog input, Event inputs Not provided, Output: Linear current 1-point, Terminal block, Black	<input checked="" type="checkbox"/> Visible	
<input checked="" type="checkbox"/> Digital Temperature Controller	E5DC-CX2ASM-015	100 to 240 VAC, 1-point input, Platinum resistance thermometer/Thermocouple/Infrared Thermosensor/Analog input, Event inputs Not provided, Output: Linear current 1-point, Terminal block, Black	<input checked="" type="checkbox"/> Visible	

Add to BOM LOGIN

(2) Click on the "Add to the BOMs" button.

Suggested accessories will appear, when "Visible" is chosen.

↓

●To add to existing lists :
Tick the boxes to select a list(s) and click on the "Add to the selected list" button.

Add to BOM

Item(s) to be added to the BOM

- E5DC-CX0ASM-015
- E5DC-CX0DSM-015
- E5DC-CX2ASM-015

Add to the existing list

Folder/List Name	Folder/List Description	Updated Date
<input checked="" type="checkbox"/> factory device for a control panel parts		2016-06-24
<input type="checkbox"/> factory device for a control panel parts		2016-06-24

Add to the selected list

Create a new list

Folder Required

New List creation

Name

Create a list in the existing folder

IMP

Create a list (not in a folder)

List Name Required

50 letters or less

List Description

50 letters or less

Add to BOM

Close

Lists can be organized in different folders. (e.g. by each delivery recipient, etc.)

●To create a new list : Fill the required fields and click on the "Add to the BOMs" button.

*The instruction image may be different from the actual web pages.

● How to view/use BOMs

① To view BOMs

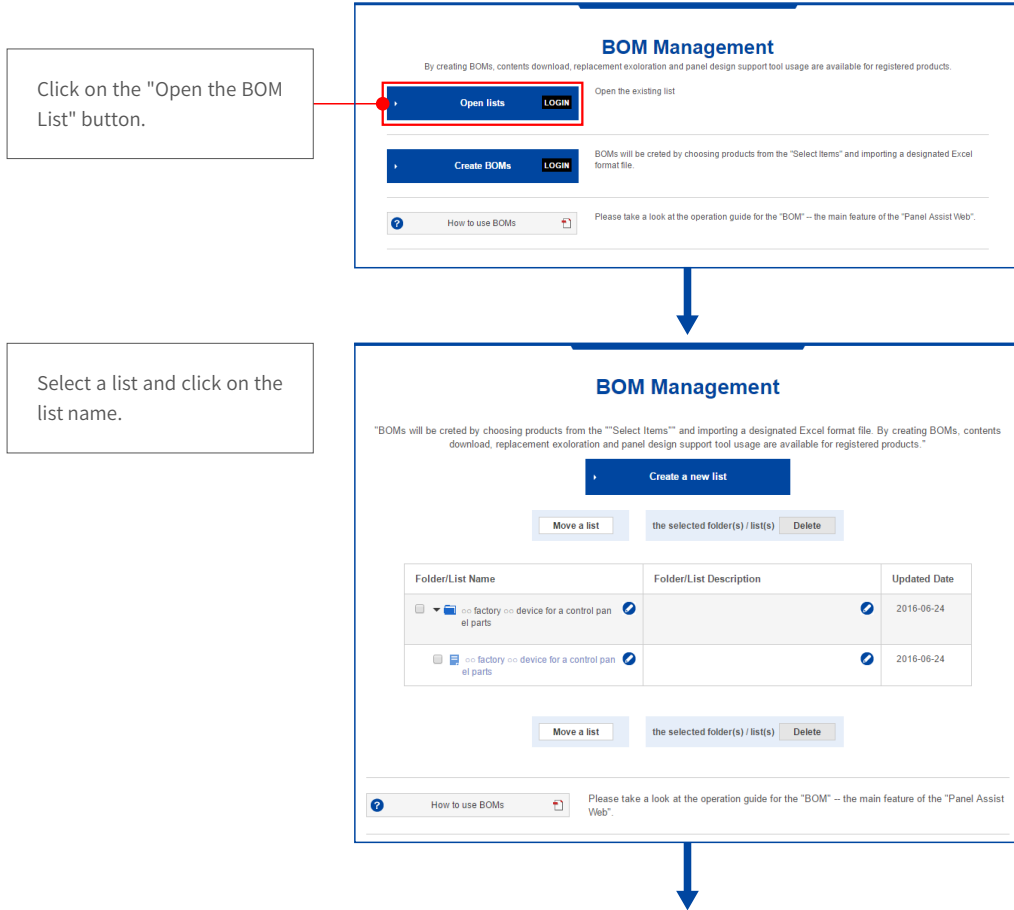

To view product details (Details) To view product lists (Listing)

Items will be displayed by product category.

Change view modes

All the items in a BOM will be displayed in a table.

The button to switch the view modes

*The instruction image may be different from the actual web pages.

● To view product details (Details)

The screenshot shows a web application interface for managing BOMs. At the top, there's a breadcrumb trail: "factory >> device for a control panel parts". Below this, there are tabs for "Details" and "Listing", and a date "2016-06-24" with an "Update" link. The main title is "factory >> device for a control panel parts". Below the title, there are buttons for "Copy the list", "Delete", and "Export: Excel format". There are also links for "Thermo Simulator" and "Terminal Block Support Tool". A prominent blue button says "Add an item by entering the product information".

The main content area is divided into sections. The first section is "Servomotors/Servo Drivers" with a "Latest Products" sub-section showing "G5 Series AC Servomotor/Servo Drives with built-in EtherCAT Communications" and model numbers "R88M-K, R88D-KNJ-ECT". There are buttons for "See the product details" and "Narrow down items by specs.". Below this is a detailed view for "G5 Series AC Servomotor/Servo Drives with built-in EtherCAT Communications" with model numbers "R88M-K, R88D-KNJ-ECT". It includes a "Specs. Comparison (up to 5 items)" button and a table of selected items from the BOM.

The table has columns: Device #, Model number, Manufacturer, Production Status, Quantity, and Remarks. The data rows are:

Device #	Model number	Manufacturer	Production Status	Quantity	Remarks
<input type="checkbox"/>	R88D-KN01H-ECT	omron		1	
<input type="checkbox"/>	R88D-KN01L-ECT	omron		1	
<input type="checkbox"/>	R88D-KN02H-ECT	omron		1	
<input type="checkbox"/>	R88D-KN02L-ECT	omron		1	
<input type="checkbox"/>	R88D-KN04H-ECT	omron		1	

Below the table is another "Specs. Comparison" section and a section for "Others (accessories, products outside the Panel Assist Web, discontinued products, other manufacturers' products, etc.)". This section has a similar table with columns: Device #, Model number, Product Category, Manufacturer, Production Status, Quantity, and Remarks. The data rows are:

Device #	Model number	Product Category	Manufacturer	Production Status	Quantity	Remarks
<input type="checkbox"/>	AAA-001	Power Supplies	YYY		1	
<input type="checkbox"/>	BBB-002	Timers/Time Switches	ZZZ		1	

At the bottom, there is a "Back to the BOM Management Top" button.

Callout boxes provide instructions for various features:

- To edit list names and list descriptions.
- To export a file in Excel format.
- To input product information manually (other manufacturers' items are also addible).
- To check and select from the latest products.
- To download the various contents.
- To check the Product Specs.
- To edit product information. (e.g. device #, purchased price, quantity, etc.) or remove items.
- Unidentified items and other manufactures' products.
- Replacement with Omron's current products; if a product category matches with Omron's category, the product search menu will be displayed to select items to be replaced.

*The instruction image may be different from the actual web pages.

● To view product lists (Listing)

The screenshot shows a web interface for managing BOMs. At the top, there are tabs for 'Details' and 'Listing'. Below the tabs, the breadcrumb path is 'factory > device for a control panel parts'. A date '2016-06-24' and an 'Update' button are visible. The main heading is 'factory > device for a control panel parts'. Below this, there are buttons for 'Copy the list', 'Delete', and 'Export: Excel format'. A section titled 'Apply the panel design support tool with this list' contains buttons for 'Thermo Simulator' and 'Terminal Block Support Tool'. A prominent blue button says 'Add an item by entering the product information'. Below this is a table with columns: Device #, Model number, Product Category, Manufacturer, Production Status, Quantity, and Remarks. The table contains 12 rows of data. Below the table, there are 'Edit' and 'Delete' buttons for 'the selected item(s) from BOM'. At the bottom, there is a 'Back to the BOM Management Top' button.

Callout boxes provide the following instructions:

- To edit list names and list descriptions.
- To input product information manually (other manufacturers' items are also addible)
- To edit list names and list descriptions.
- To input product information manually (other manufacturers' items can be added from here as well)
- To check the Product Specs.
- To edit product information. (e.g. device #, purchased price, quantity, etc.) or remove items.

*The instruction image may be different from the actual web pages.

